

LEGEND

SEE LEGEND ON SHEET 2

TANK DEPTH NOTE

DUE TO THE POTENTIAL SHALLOW DEPTH TO GROUNDWATER, ALL TANKS SHOULD BE PLACED AS SHALLOW AS POSSIBLE. INSTALL TOP OF TANKS NO MORE THAN 12 INCHES BELOW GRADE, IDEALLY INSTALL INLET AND OUTLET PIPES NO MORE THAN 12 INCHES BELOW GRADE.

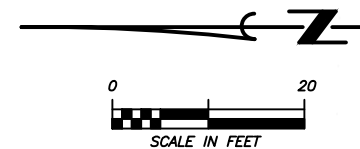

1,250 GALLON P.C.
SEE TANK DEPTH NOTE.

4" GSTP FROM 4
BEDROOM RESIDENCE

1,250 GALLON TWO COMPARTMENT
S.T. SEE TANK DEPTH NOTE.

APPROXIMATE LOCATION OF EXISTING
GRAVEL DRIVEWAY (PER DR STRONG
SEPTIC SYSTEM PLANS REFLECTING
PROPOSED DRIVEWAY)

APPROXIMATE
PROPERTY LINE

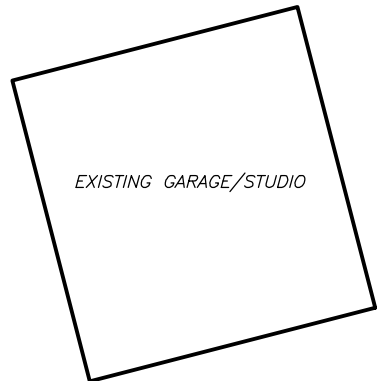

EXISTING GARAGE/STUDIO

4" GSTP, INSTALL AT 1% MINIMUM SLOPE WITH NO
MORE THAN 1" FALL BETWEEN TANKS (**CRUCIAL TO
MAINTAIN SURGE CAPACITY IN P.C.**)

100' WELL SETBACK FROM
EXISTING WELL

800'± 1.5" SCH. 40 PETP. ALL
PORTIONS OF THE PETP SHALL BE
INSTALLED AT AN ELEVATION
LOWER THAN LAT. 1.

FOUND SURVEY
MARKERS, LS32439

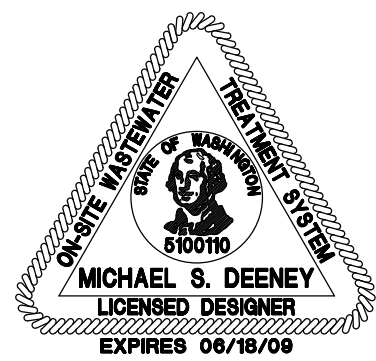

NOTE:
THIS IS A PLANNING DOCUMENT ONLY
NOT FOR CONSTRUCTION UNTIL
SEPTIC PERMIT IS APPROVED
BY THE HEALTH DEPARTMENT

December 17, 2010 4:38:52 p.m.
Drawing: VOGLEY SEPTIC DESIGN (WEB SITE VER.).DWG.DWG
© CREATIVE DESIGN SOLUTIONS 2008

REVISION	DATE
DRAWN BY: MICHAEL S. DEENEY	
SHEET 3 OF 11	DATE: 8/1/08

SEPTIC SYSTEM, PARCEL #701253005
SITE PLAN DETAIL "A"
FOR: KIM VOGLEY

25(27-1W)



CREATIVE DESIGN SOLUTIONS
Septic System Designs, Permits, & Inspections
P.O. BOX 2787, PORT ANGELES, WASHINGTON 98362
(800) 395-7296, (360) 457-6353, EMAIL: MIKE@CDS4YOU.COM